



USER MANUAL





MHS2700



Lift Scale



Please keep the instruction manual at hand all the time for future reference.

Explanation of Text/Symbols on Device Label/Packaging

Text/Symbol	Meaning
	Caution, consult accompanying documents before use
	Separate collection for waste of electrical and electronic equipment, in accordance with Directive 2002/96/EC. Do not dispose of device with everyday waste
	Name and address of device manufacturer, and year/country of manufacture
	Carefully read user manual before installation and usage, and follow instructions for use.
	Medical electrical device, Type B applied part
REF	Device catalogue number / model number
EC REP	Name and address of authorized representative in the European Union
MD	Device is a medical device. Text indicates device category type
LOT	Manufacturer's batch or lot number for device
SN	Device's serial number
UDI	Device's Unique Device Identifier
e	Value in mass units (verified models only). This is the difference between two consecutive display values, used to classify and verify a scale
CE 2460	Device conforms to (EU) 2017/745 Regulation on Medical Devices. Four digit number is identifier for medical device Notified Body
CE M 20 0122	Device complies with EC directives (verified models only) M :Conformity label in compliance with Directive 2014/31/EU for non-automatic weighing instruments 20 :Year in which conformity verification was performed and the CE label was applied. (ex: 20=2020) 0122 : Identifier for metrology Notified Body
UK CA M 20 8506	Device complies with UK directives (verified models only) M : Conformity label in compliance with Non-automatic Weighing instruments Regulations 2016 20 : Year in which conformity verification was performed and the UKCA label was applied. (ex: 20=2020)

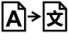
	8506: Identifier for metrology Notified Body
	Device is a Class III scale in compliance with Directive 2014/31/EU (verified models only)
	Name and address of entity importing device (if applicable)
	Name and address of entity responsible for translating Information For Use (if applicable)

Copyright Notice

Charder Electronic Co., Ltd.

No.103, Guozhong Rd., Dali Dist., Taichung City41262Taiwan

Tel: +886-4-2406 3766

Fax: +886-4-2406 5612

Website: www.chardermedical.com E-mail: info_cec@charder.com.tw

Copyright© Charder Electronic Co., Ltd. All rights reserved.

This user manual is protected by international copyright law. All content is licensed, and usage is subject to written authorization from Charder Electronic Co., Ltd. (hereinafter Charder) Charder is not liable for any damage caused by a failure to adhere to requirements stated in this manual. Charder reserves the right to correct misprints in the manual without prior notice, and modify the exterior of the device for quality purposes without customer consent.



Charder Electronic Co., Ltd.
No. 103, Guozhong Rd., Dali Dist.,
Taichung City, 41262 Taiwan

CONTENTS

I. Safety Notes	5
A. General Information	5
B. EMC Guidance and Manufacturer's Declaration	8
II. Installation	12
A. Safety Warnings	12
B. Inserting Batteries	18
III. Indicator and Key Functions	19
IV. Using Device	21
A. Basic Operation	21
B. Hold	21
C. BMI	22
D. Tare	22
V. Device Setup	23
VI. Wireless Connection	24
VII. Troubleshooting	25
VIII. Product Specifications	27
IX. Declaration of Conformity	28



I. Safety Notes

A. General Information

Thank you for choosing this Charder Medical device. It is designed to be easy and straightforward to operate, but if you encounter any problems not addressed in this manual, please contact your local Charder service partner.

Before beginning operation of the device, please read this user manual carefully, and keep it in a safe place for reference. It contains important instructions regarding installation, proper usage, and maintenance.

Intended Purpose

This medical device is designed to be used in accordance with national regulations, to measure weight within specifications, for weight-related usage by professionals.

Clinical Benefit

Measurement results can be used by professionals to monitor weight-related issues

General Handling

- Ensure all parts are properly locked and tightened before operating the device.
- Device is intended to measure one subject at a time.

Safety Instructions

- Batteries should be kept away from children. If swallowed, promptly seek medical assistance.
- The device has an expected service life of 5 years when correctly handled, serviced, and periodically inspected in accordance with manufacturer's instructions.
- Always comply with appropriate regulations when using electrical components under increased safety requirements.
- Improper installation will render the warranty null and void.
- The device is intended for indoor use only.
- Observe permissible ambient temperatures for use
- Device meets requirements for electromagnetic compatibility. Do not exceed the maximum values specified in the applicable standards.
- This device should only be attached to compatible patient lift systems
- Do not lean against device, to minimize falling risk.
- Device must not be modified. Any unauthorized modification will void

warranty, and Charder is not responsible for resulting damage.

- Do not exceed maximum loading capacity.
- Maximum safe overload is 6 times maximum capacity of device. (device will beep when loading exceeds maximum capacity)

Environmental

- All batteries contain toxic compounds; batteries should be disposed of via designated competent organizations. Batteries should not be incinerated.

Cleaning

- Device surface should be cleaned using alcohol-based wipes. Corrosive cleansing liquids should not be used. Pressure-washers should not be used.
- Do not use large amounts of water when cleaning the device, as it may cause damage to the internal electronics.

Maintenance

- Please contact your local Charder distributor for regular maintenance and calibration.
- Device does not require routine user maintenance. However, regular checking of accuracy is recommended; frequency to be determined by level of use and state of device, or local metrology/measuring instrument regulations if applicable. If results are inaccurate, please contact local distributor.

Warranty/Liability

- The period of warranty shall be eighteen (18) months, beginning on the date of purchase. Please retain your receipt as proof of purchase.
- No responsibility shall be accepted for damage caused through any of the following reasons: unsuitable or improper storage or use, incorrect installation or commissioning by the owner or third parties, natural wear and tear, changes or modifications, incorrect or negligent handling, chemical, electrochemical, or electrical interference, unless damage is attributable to negligence on the part of Charder.
- This device does not contain any user-maintained parts. All maintenance, technical inspections, and repairs should be conducted by an authorized Charder service partner, using original Charder accessories and spare parts. Charder is not liable for any damages arising from improper maintenance or usage. Dismantlement of the device will void the warranty.

Disposal

- This product is not to be treated as regular household waste, but should be taken to a designated collection points for electronics. Further information should be provided by local waste disposal authorities.



Warning

- Keep device away from liquids.
- Do not under any circumstances dismantle or alter the device, as this could result in electric shock or injury as well as adversely affect the precision of measurements.
- Do not place the device in direct sunlight, or in close proximity to an intense heat source. Excessively high temperatures may damage the internal electronics.

Incident Reporting

- Any serious incident that has occurred in relation to the device should be reported to the manufacturer, EU representative (if device is used in EU member state), and competent authority of user/subject's member state.

B. EMC Guidance and Manufacturer's Declaration

Guidance and manufacturer's declaration-electromagnetic emissions

The MHS2700 Lift Scale is intended for use in the electromagnetic environment specified below. The customer or the user of the device should assure that it is used in such an environment.

Emission test	Compliance	Electromagnetic environment-guidance
RF emissions CISPR 11	Group 1	The device uses RF energy only for its internal function. Therefore, its RF emissions are very low and are not likely to cause any interference in nearby electronic equipment.
RF emissions CISPR 11	Class B	The device is suitable for use in all establishments, including domestic establishments and those directly connected to the public low-voltage power supply network that supplies buildings used for domestic purposes.
Harmonic emissions IEC 61000-3-2	Class A	
Voltage fluctuations /flicker emissions IEC 61000-3-3	Compliance	

Guidance and manufacturer's declaration-electromagnetic immunity

The MHS2700 Lift Scale is intended for use in the electromagnetic environment specified below. The customer or the user of the device should assure that it is used in such an environment.

Immunity test	IEC 60601 test level	Compliance level	Electromagnetic environment-guidance
Electrostatic discharge(ESD) IEC 61000-4-2	<u>± 8 kV contact</u> <u>± 2 kV, ± 4 kV,</u> <u>± 8 kV, ± 15 kV</u> <u>air</u>	<u>± 8 kV contact</u> <u>± 2 kV, ± 4 kV,</u> <u>± 8 kV, ± 15 kV</u> <u>air</u>	Floors should be wood, concrete or ceramic tile. If floors are covered with synthetic material, the relative humidity should be at least 30%

Electrical fast transient/burst IEC 61000-4-4	± 2kV for power supply lines + 1kV for input/output lines	+ 2kV for power supply lines + 1kV for input/output lines	Mains power quality should be that of a typical commercial or hospital environment.
Surge IEC 61000-4-5	± 1kV line(s) to line(s) ± 2kV line(s) to earth	+ 1kV line(s) to line(s) + 2kV line(s) to earth	Mains power quality should be that of a typical commercial or hospital environment.
Voltage Dips, short interruptions and voltage variations on power supply input lines IEC 61000-4-11	<u>0% UT for 0,5 cycle</u> <u>0% UT for 1 cycle</u> <u>70% UT(30% dip in UT) for 25 cycles</u> <u>0% UT for 5 s</u>	<u>0% UT for 0,5 cycle</u> <u>0% UT for 1 cycle</u> <u>70% UT(30% dip in UT) for 25 cycles</u> <u>0% UT for 5 s</u>	Mains power quality should be that of a typical commercial or hospital environment. If the user of the device requires continued operation during power mains interruptions, it is recommended that the device be powered from an uninterruptible power supply or a battery.
Power frequency(50/60 Hz) magnetic field IEC 61000-4-8	<u>30 A/m</u>	<u>30 A/m</u>	The device power frequency magnetic fields should be at levels characteristic of a typical location in a typical commercial or hospital environment.
NOTE UT is the a.c. mains voltage prior to application of the test level.			

Guidance and manufacturer's declaration-electromagnetic immunity

The MHS2700 Lift Scale is intended for use in the electromagnetic environment specified below. The customer or the user of the device should assure that is used in such an environment.

Immunity test	IEC 60601 test level	Compliance level	Electromagnetic environment-guidance
Conducted RF IEC 61000-4-6	3 Vrms 150 KHz to 80 MHz	3 Vrms 150 KHz to 80 MHz	Portable and mobile RF communications equipment should be used no closer to any part of the device including cables, than the recommended separation distance calculated from the equation applicable to
Radiated RF IEC 61000-4-3	<u>6 V in ISM bands between 0,15 MHz and 80 MHz</u> <u>80 % AM at 1 kHz</u> 3 V/m	<u>6 V in ISM bands between 0,15 MHz and 80 MHz</u> <u>80 % AM at 1</u>	

	80MHz to 2,7 GHz	<u>kHz</u> 3 V/m <u>80MHz to 2,7 GHz</u>	the frequency of the transmitter. Recommended separation distance: $d = 1,2 \sqrt{P}$ $d = 1,2 \sqrt{P}$ 80MHz to 800 MHz $d = 2,3 \sqrt{P}$ 800MHz to 2,5 GHz Where P is the maximum output power rating of the transmitter in watts (W) according to the transmitter manufacturer and d is the recommended separation distance in metres (m). Field strengths from fixed RF transmitters, as determined by an electromagnetic site survey ^a , should be less than the compliance level in each frequency range ^b . Interference may occur in the vicinity of equipment marked with the following symbol: 
--	------------------	--	--

NOTE1 At 80 MHz and 800 MHz, the higher frequency range applies.

NOTE2 These guidelines may not apply in all situations. Electromagnetic propagation is affected by absorption and reflection from structures, objects and people.

a Field strengths from fixed transmitters, such as base stations for radio (cellular/cordless) telephones and land mobile radios, amateur radio, AM and FM radio broadcast and TV broadcast cannot be predicted theoretically with accuracy. To assess the electromagnetic environment due to fixed RF transmitters, an electromagnetic site survey should be considered. If the measured field strength in the location in which the device is used exceeds the applicable RF compliance level above, the device should be observed to verify normal operation. If abnormal performance is observed, additional measures may be necessary, such as re-orienting or relocating the device.

b Over the frequency range 150 kHz to 80 MHz, field strengths should be less than 3 V/m.

Recommended separation distance between portable and mobile RF communications equipment and the MHS2700 Lift Scale

The device is intended for use in an electromagnetic environment in which radiated RF disturbances are controlled. The customer or the user of the device can help prevent electromagnetic interference by maintaining a minimum distance between portable and mobile RF communications equipment (transmitters) and the device as recommended below, according to the maximum output power of the communications equipment.

Rated maximum output power of transmitter W	Separation distance according to frequency of transmitter m		
	150 kHz to 80 MHz $d = 1,2\sqrt{P}$	80 MHz to 800 MHz $d = 1,2\sqrt{P}$	800 MHz to 2,5 GHz $d = 2,3\sqrt{P}$
0,01	0,12	0,12	0,23
0,1	0,38	0,38	0,73
1	1,2	1,2	2,3
10	3,8	3,8	7,3
100	12	12	23

For transmitters rated at a maximum output power not listed above, the recommended separation distance d in metres (m) can be estimated using the equation applicable to the frequency of the transmitter, where p is the maximum output power rating of the transmitter in watts (W) according to the transmitter manufacturer.

NOTE1 At 80 MHz and 800 MHz, the separation distance for the higher frequency range applies.

NOTE2 These guidelines may not apply in all situations. Electromagnetic propagation is affected by absorption and reflection from structures, objects and people.

II. Installation

A. Safety Warnings

Lift Scale must NOT tilt at any time

1. Lift scale must NOT tilt when installed on Patient Lift System.

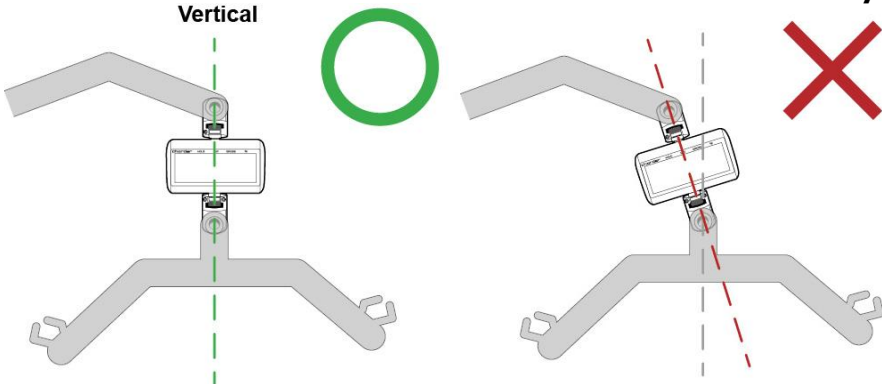

If Lift Scale is tilted and not completely vertical when installed, this will cause the joints of the Lift Scale to bend. This will eventually cause breakage once used enough times and subjected to enough weight, because force is being applied against joints in a way that they aren't designed to handle.

2. Lift Scale must NOT tilt at any time during Patient Lift System's operation.

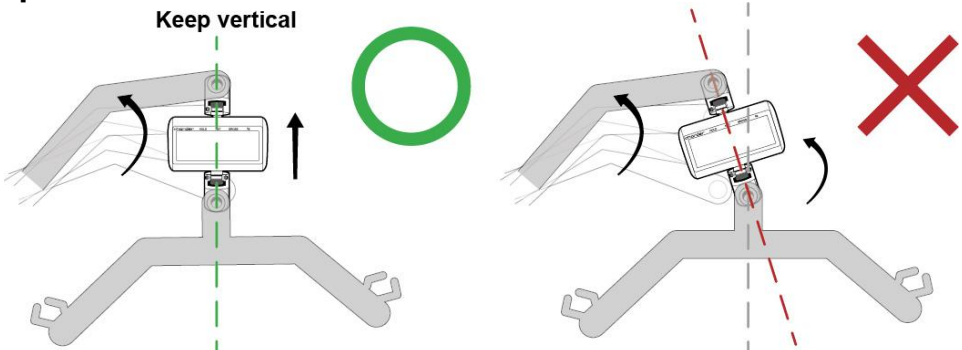

Even if Lift Scale is completely vertical when installed, if it is bent at any point in operation (ex: Patient Lift System raises patient to higher point for weight measurement), the same risk of breakage applies.

IMPORTANT: If tilt or bending is observed at any time, the Lift Scale must NOT be used.

Inspect cardan joints before use for signs of damage or looseness

1. Inspect cardan joints connecting Lift Scale to Patient Lift System visually before use.

The Lift Scale is designed to be installed between the lifting bar and hanger of the Patient Lift System, in a completely vertical position.

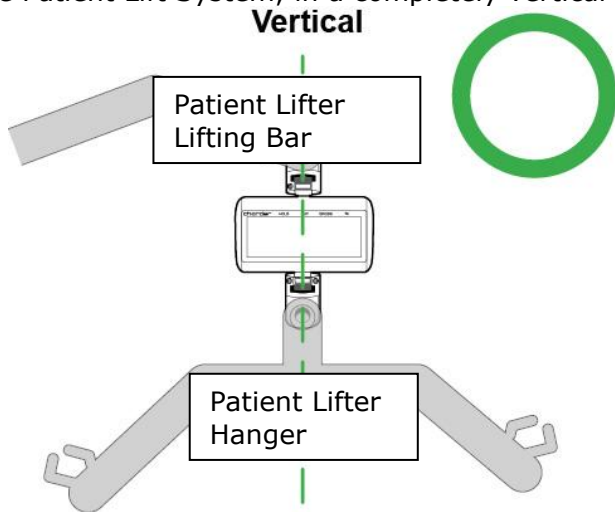

Both top and bottom cardan joints should be inspected for bending.

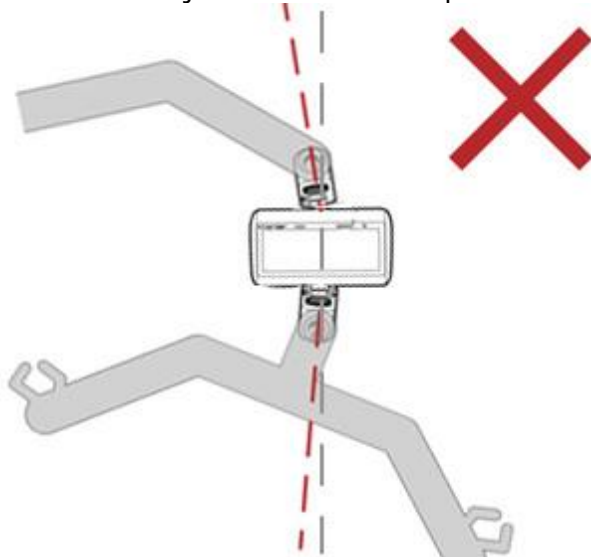

If any visual damage or bending is observed, do NOT use Lift Scale.

2. If no visual damage is observed, the Lift Scale should be twisted manually to test if incorrect movement is possible.

Charder Lift Scales should be installed on Patient Lift Systems utilizing 360-degree swivel bearings. Rotation should be conducted using **Lift System**, rather than device.

The cardan joints on MHS2500I / MHS2600I / MHS2700 Lift Scales (with **fixed** cardan joints) do NOT swivel. If they can be manually twisted, that means the joints are damaged, and the Lift Scale should NOT be used.



(MHS2500I / MHS2600I / MHS2700 non-rotating cardan joint model)

The cardan joints on MHS2510I / MHS2610I / MHS2710 Lift Scales (with **rotating** cardan joints) will swivel, but only **horizontally**. If they can be manually twisted in any other direction, that means joints are damaged, and the Lift Scale should NOT be used Scale.

3. Lift Scale and hanger bar must be allowed free movement in all directions.

If Lift Scale is obstructed from free movement, twisting force will be applied to Lift Scale, potentially causing damage.

Lift Scale should be installed on Patient Lift System that allows 360-degree free swivel

1. Rotation should be conducted by 360-degree free swivel Patient Lift System.



Even if the MHS2510I / MHS2610I / MHS2710 Lift Scales with horizontally-rotating cardan joints are used, rotation should be conducted by the Patient Lift System, and not the Lift Scale, to minimize risk of damage to Lift Scale.

Nylock Screws must be screwed in tightly according to specifications

Nylock Screws must be secured according to correct assembling procedure. Prepare one hexagon screwdriver and one torque wrench.

1. Hold/fix one side using screwdriver

2. Tighten/attach Nylock Screws using torque wrench (repeat from other side)

IMPORTANT: Torque strength must be set at 18kgf-cm \pm 1kgf-cm

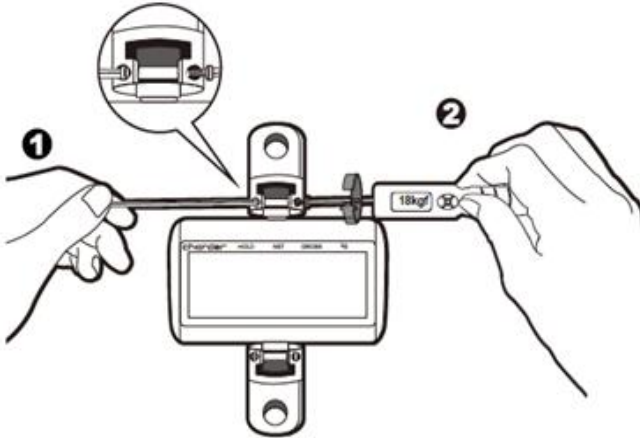

IMPORTANT: Nylock Screw must be secured from both sides (one side with screwdriver, other side by torque wrench). Nylock Screw will not tighten, and will simply rotate in place if counter-force from other side is not applied.

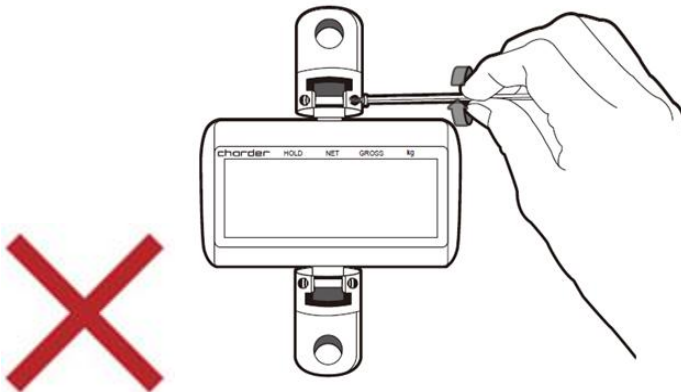

Check to ensure all screws are fully tightened

No.	Item	Qty
A	Hexagon Nylock screw	2 screws per joint
B	Stopper screw	1 screw per joint

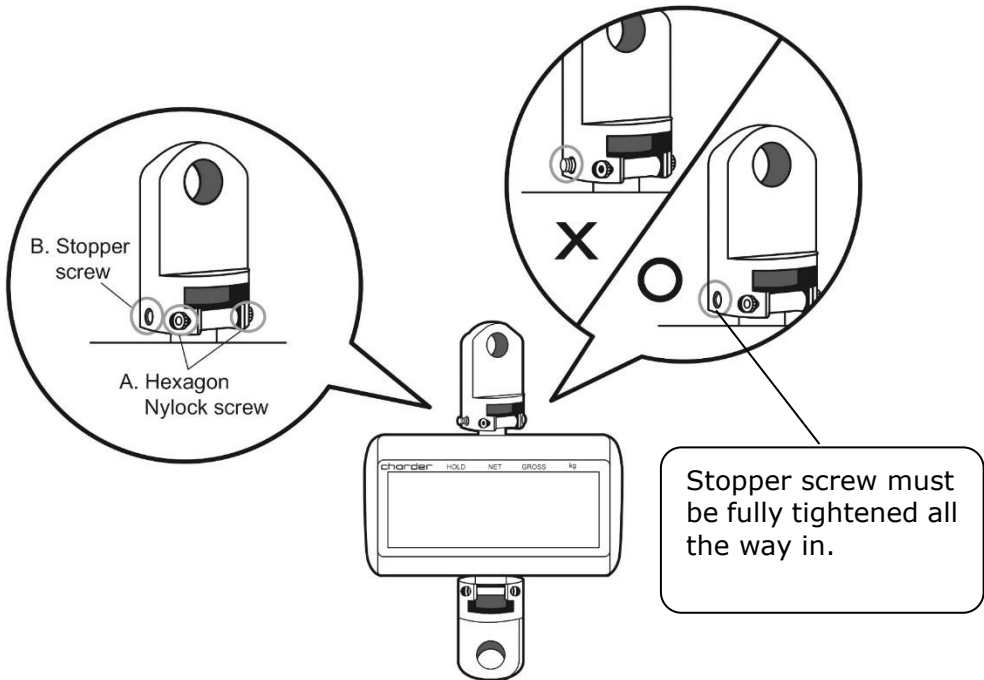

CAUTION: DO NOT use the Lift Scale if any screws are loose.

B. Inserting Batteries

The device utilizes a rechargeable battery pack.

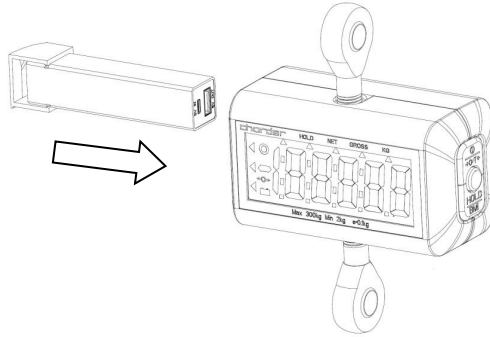

When power is low, please recharge the battery pack using the micro-USB port. When the port light is blinking **red**, battery is being charged. When the port light is stable **green**, battery is fully charged.

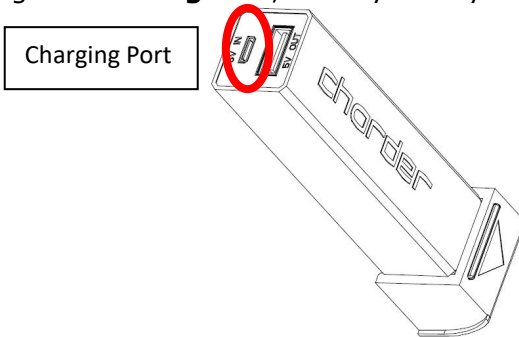

IMPORTANT (SAFETY NOTICE):

- Charging should only be done with approved Charder charger.
- Charging should be performed in a fire-safe area, away from children or pets.
- Charging should be performed at a temperature between **10°C and 45°C**. Never charge batteries unattended, or where objects such as carpet, furniture, wood or vinyl floors, curtains or other flammable objects are present.
- Do not attempt to charge a battery that is swollen or bulging.
- Batteries should be stored in a cool and dry place when not in use.
- If used frequently, batteries can be stored at full charge. However, to maximize battery life, infrequently batteries should not be stored at full charge.
- Batteries in long-term storage should be fully charged every three months or so to avoid depletion and battery damage.

III. Indicator and Key Functions



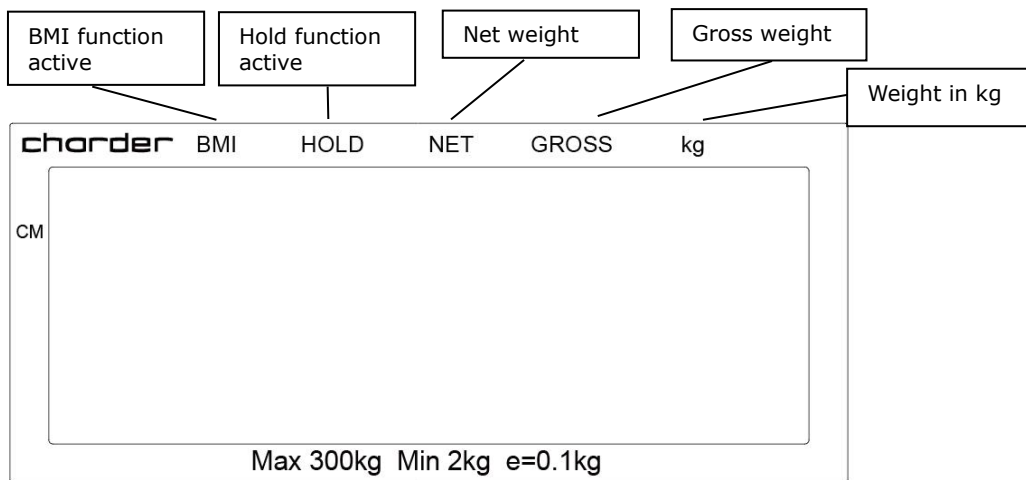

Device indicator (3 key OIML model)

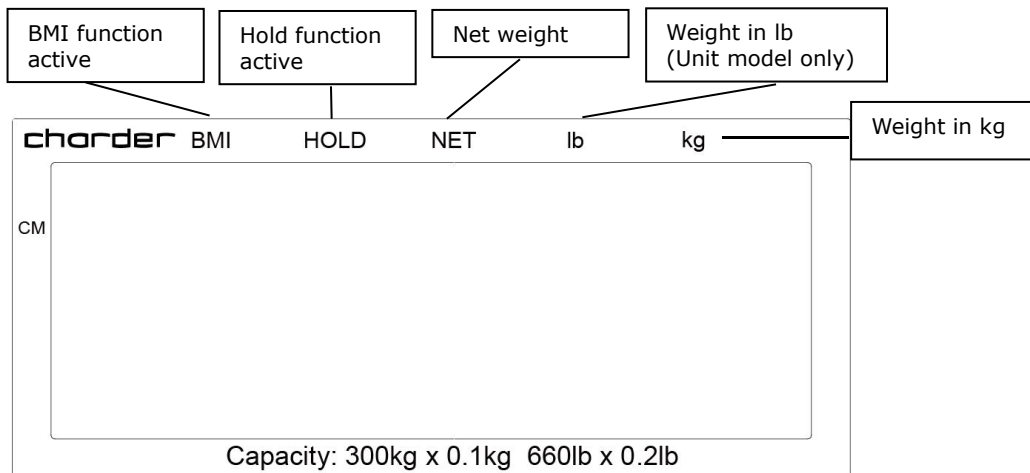

Device indicator (3-key Unit model)



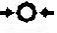

Display

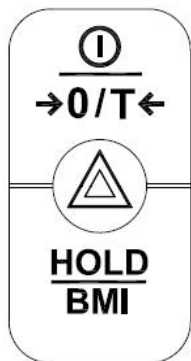
-  : Wireless
-  : Stable
-  : Negative weight
-  : Zero
-  : Battery



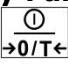

Key Function (3-key OIML model)

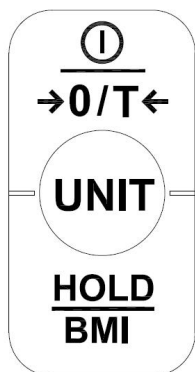
1. : Power on or power off. Reset display to 0.0 kg display. Press and hold for 3 seconds to turn off. Press to increase height when in BMI mode.
2. : Press to decrease height when in BMI mode. Press and hold for 3 seconds to enter device settings
3. : Determine stable weighing value - used when weight is unstable. Press and hold for 3 seconds to enter BMI mode. Press to confirm height input when in BMI model.

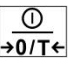

Key Function (3-key Unit model)

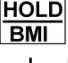
1. : Power on or power off. Reset display to 0.0 kg display. Press and hold for 3 seconds to turn off. Press to increase height when in BMI mode.
2. : Switch between kg and lb. Last-used unit will be stored in memory. Press to decrease height when in BMI mode. Press and hold for 3 seconds to enter device settings
3. : Determine stable weighing value - used when weight is unstable. Press and hold for 3 seconds to enter BMI mode. Press to confirm height input when in BMI model.

IV. Using Device

A. Basic Operation

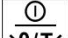
Switch on the device using  key. The device will automatically perform self-calibration, displaying software version.

Once "0.00 kg" appears on indicator, device is ready for measurement.

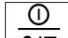
Note: If "0.00 kg" does not display on indicator, press  key to zero the device.



Guide subject to sit upon sling (or other device connected to lift). After the weight has stabilized, the "stable" symbol will appear on indicator.

Note: If subject's weight exceeds scale capacity (including tare), indicator will display "Err" prompt due to overload.

B. Hold





The hold function determines average weight, designed to be used if subject's weight will not stabilize (ex: an active child).

Note: if fluctuation is too severe, average weight determination will be difficult and hold may not function correctly

1. Switch on the device normally.
2. Press the  key. "HOLD" will be displayed on the indicator.
3. Conduct measurement as usual.
4. After a few seconds, the average weight will be displayed on the indicator. This weight will be locked - at this point, subject movement will not affect weight.
5. To release the locked weight, press the  key again to return to the device to normal mode.

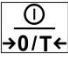
Note: Hold function can be activated before or after subject sits in sling.

C. BMI

1. In normal mode, press and hold  key to enter BMI mode.
2. Display will show last recorded height. Digits will flash.
3. Press  key to increase height, [] or  to decrease height. Press and hold to speed up.
4. After inputting height, press  to confirm.
5. Proceed to weigh subject as usual. Indicator will display weight, height, and BMI.

NOTE: Hold function can be used at this time if weight is unstable

6. Press  key to return to normal mode.

Category	BMI (kg/m ²)	Risk of obesity-related disease
Under	< 18.5	Low
Normal	18.5-24.9	Average
Over	24.9-29.9	Slightly Increased
Obese I	30.0-34.9	Increased
Obese II	35.0-39.9	High
Obese III	> 40	Very High

(World Health Organization adult BMI standards)

NOTE: though BMI is calculated in the same way, subjects under the age of 18 should use separate standards for interpretation, in comparison with percentile charts for their age group.

D. Tare

The tare function allows the user to deduct the weight of objects from the device's measurement result.

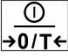
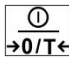
1. Place object that needs to be tared onto sling.
2. Press  key after stable symbol appears on indicator. Display will indicate "0.00 kg".
3. Guide subject (plus tared object) to be weighed upon sling. Conduct measurement.
4. To clear tare value, remove all objects from sling, and press  key.

V. Device Setup

3-key OIML model

When the device is switched on, press and hold the Δ key for about 3 seconds, until the display shows the "SET", followed by software version.

In device setup menu:

 to toggle next menu option

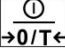
 to confirm selection / enter submenu

After changes are complete, press  until "End" appears on screen.

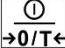
Press  to save changes. Device will automatically restart and apply changes.

Auto Power-Off:

Instruct device to shut off automatically after a certain period of time.

Auto off options: 60 sec / 120 sec / 180 sec / 240 sec / 300 sec / Off

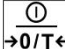
Press  to toggle between time options, and  to confirm selection.

Buzzer/Beep:

When function is turned on, beeping noise will be made when: indicator is turned on, keys are pressed, and weight is stable.

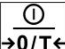
Press  to toggle between on/off, and  key to confirm selection.

3-key Unit model

When the device is switched on, press and hold the  key for about 3 seconds, until the display shows "SET", followed by software version.

In device setup menu:

 to toggle next menu option

 $\rightarrow 0/T \leftarrow$ to confirm selection / enter submenu

After changes are complete, press  until "End" appears on screen.

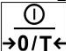
Press  $\rightarrow 0/T \leftarrow$ to save changes. Device will automatically restart and apply changes.

Auto Power-Off: 

Instruct device to shut off automatically after a certain period of time.

Auto off options: 60 sec / 120 sec / 180 sec / 240 sec / 300 sec / Off

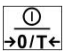
Press  to toggle between time options, and  $\rightarrow 0/T \leftarrow$ to confirm selection.

Buzzer/Beep: 

When function is turned on, beeping noise will be made when: indicator is turned on, keys are pressed, and weight is stable.

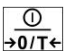
Press  to toggle between on/off, and  $\rightarrow 0/T \leftarrow$ key to confirm selection.

VI. Wireless Connection

If the device has wireless module installed, it will be activated automatically when device is turned on. Please see Charder wireless software instructions for details.

VII. Troubleshooting

Before contacting your local Charder distributor for repair service, we recommend considering the following troubleshooting procedures:

Self-inspection

1. Device will not power on

- If battery power is depleted, replace with new batteries

2. Indicator showing "00000" ZERO SPAN out of range

- Interference due to factors such as RF disturbance or ground vibration. Relocate device to location without interference and try again
- External objects interfering with device. Clear area of interfering objects and try again
- If the steps above cannot resolve the problem, re-calibration may be required to correct weighing accuracy

Distributor support required

If the following errors occur, we recommend contacting your local Charder distributor for repair or replacement services:







1. Device will not power on

- Faulty on/off key
- Broken or damaged wires causing short circuit or faulty connection
- Safety fuse burnout

2. Indicator damage

- Possible hardware defects include: uneven brightness in LCD screen, blurred text, smeared rainbow screen, incorrect decimal display
- Unable to save or read data
- Indicator shows "ErrL" after device is switched on
- Keys not responding
- Buzzer malfunction

Error Messages



Error Message	Reason	Action
	Low battery warning Voltage of battery is too low to operate device	Replace batteries
	Overload Total load exceeds device's maximum capacity	Reduce weight on measurement platform and try again
	Counting Error Signal from loadcells too low	Error normally caused by faulty loadcell or wiring. Please contact distributor
	Counting Error Signal from loadcells too high	Error normally caused by faulty loadcell or wiring. Please contact distributor
	Zero count over calibration zero range +10% while power on	Re-calibration required. Please contact distributor
	Zero count under calibration zero range -10% while power on	Re-calibration required. Please contact distributor
	Program Error Fault with device software	Please contact distributor

VIII. Product Specifications

Model		MHS2700	
Weight Measurement	Capacity	Capacity	Accuracy
		150 kg x 0.1 kg	± 150g
		175 kg x 0.1 kg	± 150g
		200 kg x 0.1 kg	± 150g
		230 kg x 0.1 kg	± 150g
		300 kg x 0.1 kg	± 150g
		400 kg x 0.2 kg	± 300g
	OIML	Class III	
	Unit	kg/lb (non-OIML model only)	
LCD Screen	1.0-inch LCD screen (5 1/2 digits)		
Dimensions	Overall	122(W) x 60(D) x 180(H) mm	
Device Weight		1.04 kg	
Key Functions		On/Off/Zero/Tare, Hold/BMI Unit (non-OIML model) △Setup (OIML model)	
Data Transmission		Wireless module (optional) NOTE: Device should be connected to network by qualified distributors only	
Power Supply		Rechargeable battery	
Operation Temperature & Humidity		0°C~40°C 35% / 90% RH	
Standard Accessories		User manual, rechargeable battery, micro-USB cable, power adapter	

IX. Declaration of Conformity

This product has been manufactured in accordance with the harmonized EU/ UK standards, following the provisions of the below stated directives:

	(EU) 2017/745 Regulation on Medical Devices Classification: Class I with measuring function
	2014/31/EU Non-automatic Weighing Instruments Directive
	Non-automatic Weighing Instruments Regulations 2016 (S.I. 2016/1152)

RoHS Directive 2011/65/EU and Delegated Directive (EU) 2015/863

Radio equipment and telecommunications terminal equipment Directive 2014/53/EU

(applicable if wireless module is used)

Part 15 of the Federal Communications Statement Rules

This device may not cause harmful interference

This device must accept interference received without causing undesired operation

Authorized EU Representative:



Obelis s.a.

Bd Général Wahis, 53
B-1030 Brussels
Belgium

Manufactured by:

Charder Electronic Co., Ltd.
No.103, Guozhong Rd., Dali Dist.,
Taichung City, 41262 Taiwan



CD-IN-1426 [165265E] 09/2022